

B 电气系统  
B ELECTRIC SYSTEM

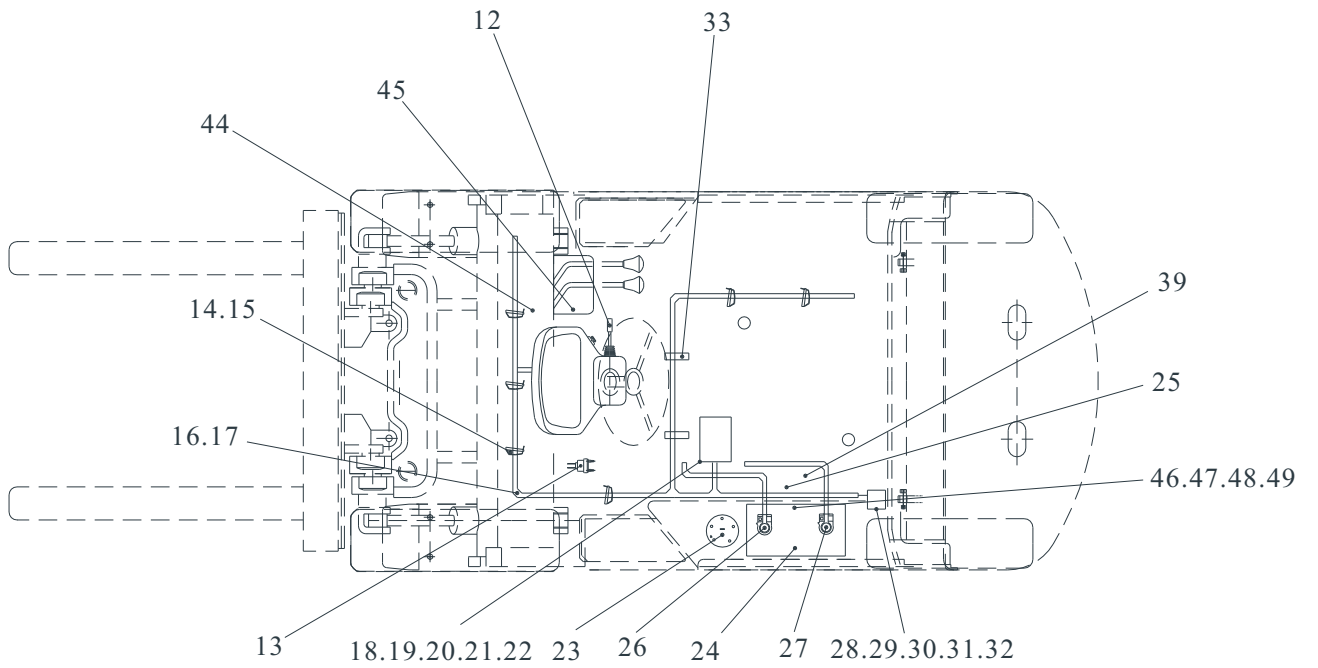
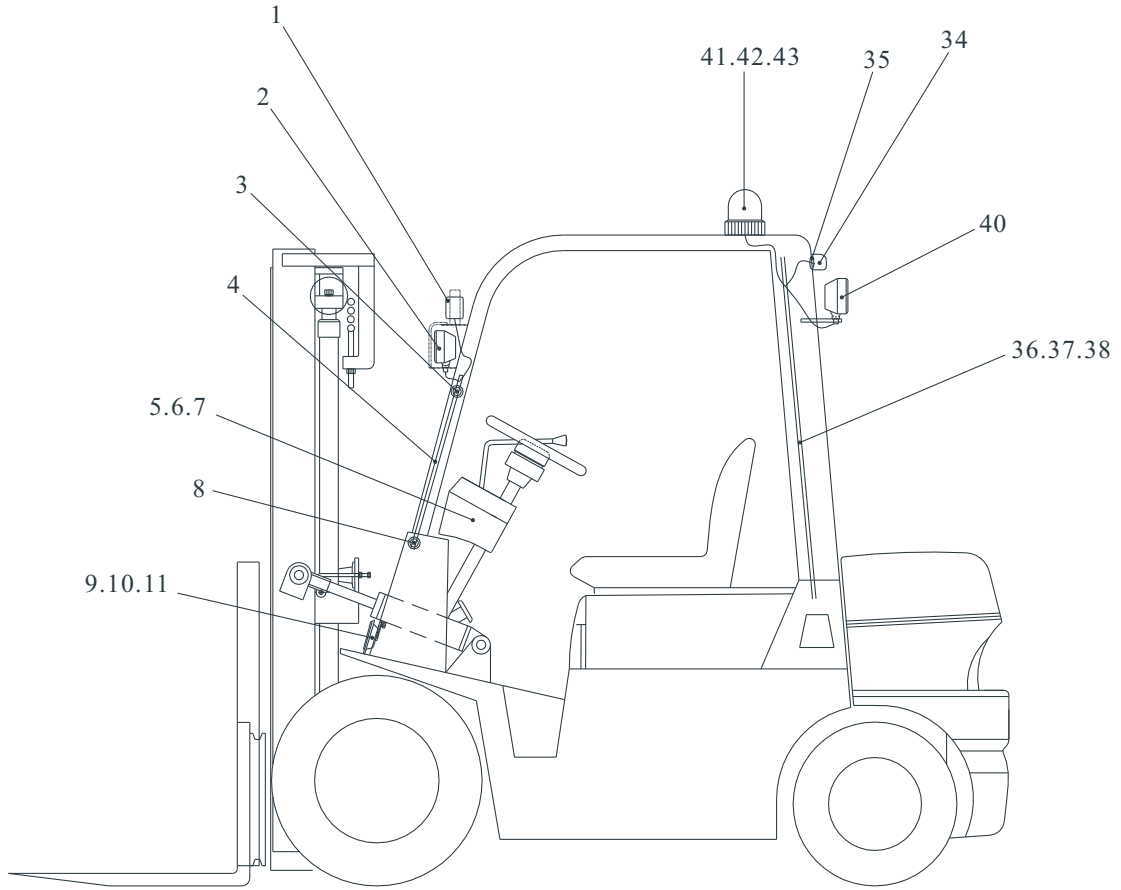

A3EA2-40001C

**B 电气系统**  
**B ELECTRIC SYSTEM**

| 序号<br>Item<br>No. | 图号<br>PartNo.      | 版本<br>Edition | 零部件名称        | Description                    | 件数<br>Q'ty | 备注<br>Remark           | 适用时间<br>Applied<br>time |
|-------------------|--------------------|---------------|--------------|--------------------------------|------------|------------------------|-------------------------|
| A                 | A3EA2-40001C       | 00            | 电气系统         | Electric system                | 1          |                        |                         |
| 01                | Z8610-12000        | 00            | 前组合灯         | Front combination<br>lamp assy | 2          | 12V                    |                         |
| 02                | Z8600-120WD        | 00            | 前大灯          | Head lamp                      | 2          | 12V                    |                         |
| 03                | A22A2-40260X3      | 00            | 出线胶圈         | Rubber ring                    | 4          | φ 34                   |                         |
| 04                | Z3652-42071H       | 00            | 前大灯线束        | Cable, head lamp               | 2          |                        |                         |
| 05                | D04ZB909-12DC      | 00            | 组合仪表         | Meter                          | 1          | 不通用钥匙<br>Particular    |                         |
| 06                | D04ZB909-<br>12DCT | 00            | 组合仪表         | Meter                          | 1          | 通用钥匙<br>Universal key  |                         |
| 07                | DJ7011-6. 3-11     | 00            | 护套           | Sheath                         | 1          |                        |                         |
| 08                | A22A2-40260X2      | 00            | 出线胶圈         | Rubber ring                    | 2          | φ 37                   |                         |
| 09                | Z8500-1D124        | 00            | 喇叭           | Horn                           | 1          | 12V                    |                         |
| 10                | B0330-08016        | 00            | 螺栓M8×16      | Bolt                           | 1          | GB5783-86              |                         |
| 11                | B5050-00008        | 00            | 弹簧垫圈8        | Washer, lock                   | 1          | GB93-87                |                         |
| 12                | Z8730-0802A        | 00            | 转向灯开关        | Switch, turn signal            | 1          |                        |                         |
| 13                | Z8740-JK205B       | 00            | 刹车灯开关        | Foot brake switch              | 1          |                        |                         |
| 14                | Z9260-80150        | 00            | 捆扎带8×150     | Belt                           | 4          |                        |                         |
| 15                | H24C2-42131        | 00            | 固定可松式锁式扎带    | Belt                           | 14         | L=110mm                |                         |
| 16                | A3722-40201        | 00            | 车身线束         | Wiring harness, body           | 1          |                        |                         |
| 17                | A3722-<br>40201NFJ | 00            | 车身线束         | Wiring harness, body           | 1          | 选用Option               |                         |
| 18                | DQH-HYC            | 00            | 集成电器盒        | Electric box                   | 1          | 见附表/See<br>attachments |                         |
| 19                | AF932-42101        | 00            | 电气元件板        | Bracket                        | 1          |                        |                         |
| 20                | B8032-06016        | 00            | 螺钉M6X16      | Screw                          | 4          | GB818-85               |                         |
| 21                | B5050-00006        | 00            | 弹簧垫圈6        | Washer, lock                   | 4          | GB93-87                |                         |
| 22                | B5111-00006        | 00            | 平垫圈6         | Washer                         | 4          | GB95-85                |                         |
| 23                | D04RG4208          | 00            | 油量传感器        | Fuel level sending<br>unit     | 1          |                        |                         |
| 24                | Z8110-12080        | 00            | 蓄电池6-QW-80MF | Battery                        | 1          |                        |                         |
| 25                | A06H2-40701        | 00            | 易熔丝          | Fuse                           | 1          |                        |                         |
| 26                | H0L32-42018        | 00            | 电瓶引线 (+)     | Cable                          | 1          |                        |                         |
| 27                | H0L32-42028        | 00            | 电瓶引线 (-)     | Cable                          | 1          |                        |                         |
| 28                | Z8510-120DZ        | 00            | 倒车蜂鸣器        | Back buzzer                    | 1          | 12V                    |                         |
| 29                | B0330-06016        | 00            | 螺栓M6×16      | Bolt                           | 1          | GB5783-86              |                         |
| 30                | B5050-00006        | 00            | 弹簧垫圈6        | Washer, lock                   | 1          | GB93-87                |                         |
| 31                | B5310-00006        | 00            | 平垫圈A级6       | Washer                         | 1          | GB97. 1-85             |                         |

**B 电气系统**  
**B ELECTRIC SYSTEM**

| 序号<br>Item<br>No. | 图号<br>PartNo. | 版本<br>Edition | 零部件名称     | Description                         | 件数<br>Q'ty | 备注<br>Remark         | 适用时间<br>Applied<br>time |
|-------------------|---------------|---------------|-----------|-------------------------------------|------------|----------------------|-------------------------|
| 32                | B4133-00006   | 00            | 螺母M6      | Nut                                 | 1          | GB6170-86            |                         |
| 33                | 3CA70-50-01   | 00            | 管夹        | Clip                                | 4          |                      |                         |
| 34                | Z8620-12000   | 00            | 后组合灯      | Rear combination<br>lamp assy       | 2          | 12V                  |                         |
| 35                | A22A2-42000A  | 00            | 后组合灯垫     | Mat                                 | 2          |                      |                         |
| 36                | H24C2-40231FS | 00            | 后护顶架线束    | Wiring harness,<br>overhead guard   | 1          |                      |                         |
| 37                | 3CC70-40-00   | 00            | 后工作灯线束    | Wiring harness, rear<br>light       | 1          | 选用Option             |                         |
| 38                | 3CC70-90-01   | 00            | 警示灯线束     | Wiring harness,<br>caution light    | 1          | 选用Option             |                         |
| 39                | Z8770-82210   | 00            | 油压报警开关    | Switch                              | 1          |                      |                         |
| 40                | Z8600-120WD   | 00            | 前大灯       | Head lamp                           | 1          | 12V, 选用<br>Option    |                         |
| 41                | XH9-3MJ       | 00            | 警示灯       | Caution light                       | 1          | 12-24V, 选用<br>Option |                         |
| 42                | H24C2-40491   | 00            | 旋转式警示灯    | Circling caution<br>light           | 1          | 12-24V, 选用<br>Option |                         |
| 43                | H24C2-40492   | 00            | 旋转带蜂鸣式闪光灯 | Alarm circling<br>caution light     | 1          | 12-24V, 选用<br>Option |                         |
| 44                | 4CC70-80-11   | 00            | 雨刮器线束     | Wiring harness,<br>windshield wiper | 1          | 选用Option             |                         |
| 45                | D07NFJ012     | 00            | 暖风机总成     | Warm air blower                     | 1          | 12V, 选用<br>Option    |                         |
| 46                | B1210-05016   | 00            | 螺钉M5×16   | Screw                               | 1          | GB818-85             |                         |
| 47                | B4133-00005   | 00            | 螺母M5      | Nut                                 | 1          | GB6170-86            |                         |
| 48                | B5050-00005   | 00            | 弹簧垫圈5     | Washer, lock                        | 1          | GB93-87              |                         |
| 49                | B5310-00005   | 00            | 平垫圈A级5    | Washer                              | 1          | GB97.1-85            |                         |

B 电器盒  
B ELECTRIC BOX

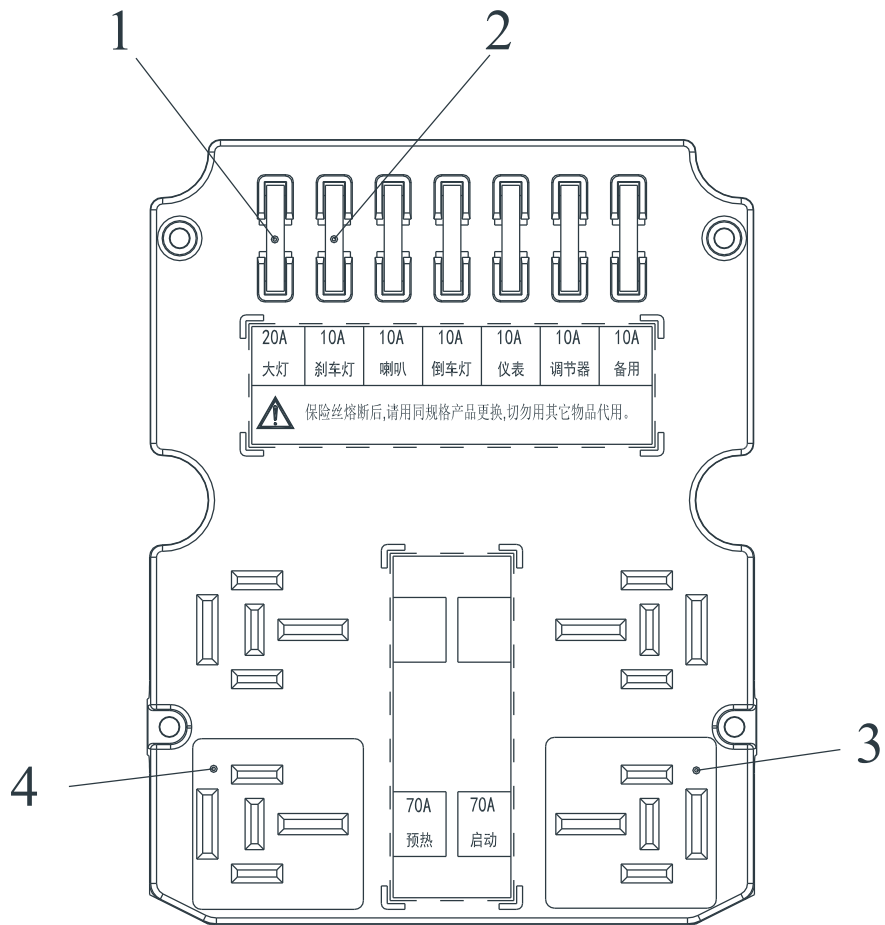
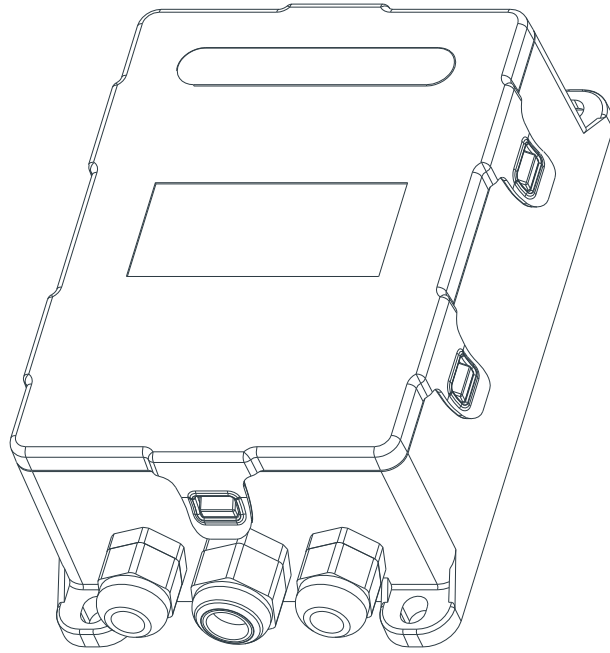

DQH-HYC

**B 电器盒**  
**B ELECTRIC BOX**

| 序号<br>Item<br>No. | 图号<br>PartNo.       | 版本<br>Edition | 零部件名称     | Description  | 件数<br>Q'ty | 备注<br>Remark | 适用时间<br>Applied<br>time |
|-------------------|---------------------|---------------|-----------|--------------|------------|--------------|-------------------------|
| A                 | DQH-HYC             | 00            | 集成电器盒     | Electirc box | 1          |              |                         |
| 01                | D06BX-20A           | 00            | 20A保险片    | Fuse         | 1          |              |                         |
| 02                | D06BX-10A           | 00            | 10A保险片    | Fuse         | 6          |              |                         |
| 03                | D07JD191-<br>70/80A | 00            | 70/80A继电器 | Relay        | 1          | 启动Starter    |                         |
| 04                | D07JD191-<br>70/80A | 00            | 70/80A继电器 | Relay        | 1          | 预热Preheat    |                         |